

Pictures reference only

PARTS NUMBER	DESCRIPTION	QTY	EFFECTIVE DATE	
1 33600-TAW-000	RR. R WINKER ASSY	1		
2 33650-TAW-000	RR. L WINKER ASSY	1		
3 33700-A7M-000	TAIL LIGHT ASSY.	1		
3 33702-A8D-000	TAIL LIGHT LENS	1		
3 34906-A8D-000	TAIL LIGHT BULB	1		
4 75581-T53-000	SET SPG LOCK KEY	1		
5 77236-T53-000	WASHER SEAT LOCK	1		
5 77236-HAA-000	SEAT LOCK WASHER	1	3/17/08	Y
6 77239-T53-000	KEY SEAT LOCK	1		
7 8350G-A7A-000-SO	R.BODY COVER ASSY S-421S	1		
7 8350G-A7A-000-ZJ	R.BODY COVER ASSY RY-151CP	1		
7-1 87125-A7A-000	BODY COVER STRIPE	1		
7 8350G-A7A-600-QC	R.BODY COVER ASSY(BR-7529S/WH-009U)	1		
7 8350G-A7A-600-QF	R.BODY COVER ASSY (RY-151CP/WH-009U)	1		
7-2 87128-A7A-600	BODY COVER STRIPE	1		
7 8350G-A7A-600-QA	R BODY COVER ASSY. WH-009U	1		
7-1 87128-A7A-600	BODY COVER STRIPE	1		
7 8350G-A7A-600-ZJ	R.BODY COVER ASSY RY-151CP	1		
7-1 87128-A7A-600	BODY COVER STRIPE	1		
7 8350G-A7A-600-VI	R BODY COVER ASSY.(R-200C)	1		
7-1 87128-A7A-600	BODY COVER STRIPE	1		
7 8350G-A7A-600-RD	R BODY COVER ASSY. (PK-1905P)	1		
7-1 87128-A7A-600	BODY COVER STRIPE	1		
7 8350G-A7A-600-AI	R BODY COVER ASSY. (BR-7529S)	1		

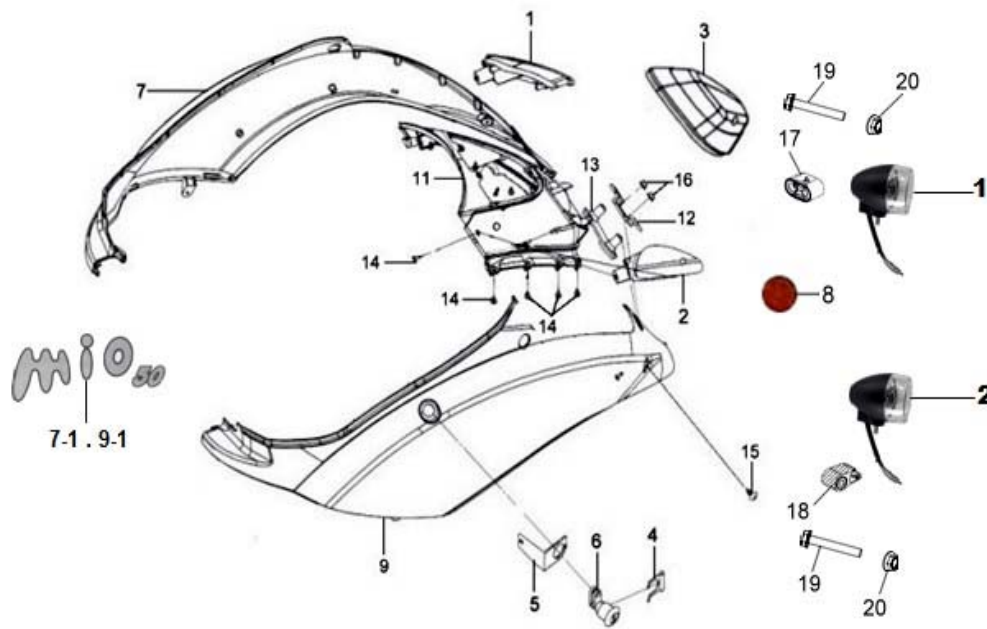

Pictures reference only

PARTS NUMBER	DESCRIPTION	QTY	EFFECTIVE DATE
7-1 87128-A7A-600	BODY COVER STRIPE	1	
7 8350G-A7Y-000-FP	R BODY COVER ASSY.BU-288S/WH-009U	1	
7-1 87127-A7Y-000	BODY COVER STRIPE	1	
7 8350G-A7W-000-JU	R BODY COVER ASSY.BK-150C/WH-009U	1	
7-1 87127-A7W-000	R BODY COVER STRIPE	1	
7 83500-A8B-000-VI	R.BODY COVER (R-200)	1	
7-1 87128-A7A-600	BODY COVER STRIPE	1	
7 83500-A8B-000-JL	R BODY COVER BK-150P	1	
7-1 87128-A7A-600	BODY COVER STRIPE	1	
7 83500-A8B-000-ZJ	R.BODY COVER RY-151C	1	
7-1 87128-A7A-600	BODY COVER STRIPE	1	
7 83500-A8B-000-AI	R.BODY COVER ASSY(BR-7529P)	1	
7-1 87128-A7A-600	BODY COVER STRIPE	1	
8 33742-F3H-000	SIDE REFLEX REFLECTOR	2	
9 8360G-A7A-000-SO	L.BODY COVER ASSY S-421S	1	
9 8360G-A7A-000-ZJ	L.BODY COVER ASSY RY-151CP	1	
9-1 87125-A7A-000	BODY COVER STRIPE	1	
9 8360G-A7A-600-QC	L.BODY COVER ASSY(BR-7529S/WH-009U)	1	
9 8360G-A7A-600-QF	L.BODY COVER ASSY (RY151CP/WH-009U)	1	
9-2 87128-A7A-600	BODY COVER STRIPE	1	
9 8360G-A7A-600-QA	L BODY COVER ASSY. WH-011S	1	
9-1 87128-A7A-600	BODY COVER STRIPE	1	
9 8360G-A7A-600-ZJ	L.BODY COVER ASSY RY-151CP	1	
9-1 87128-A7A-600	BODY COVER STRIPE	1	

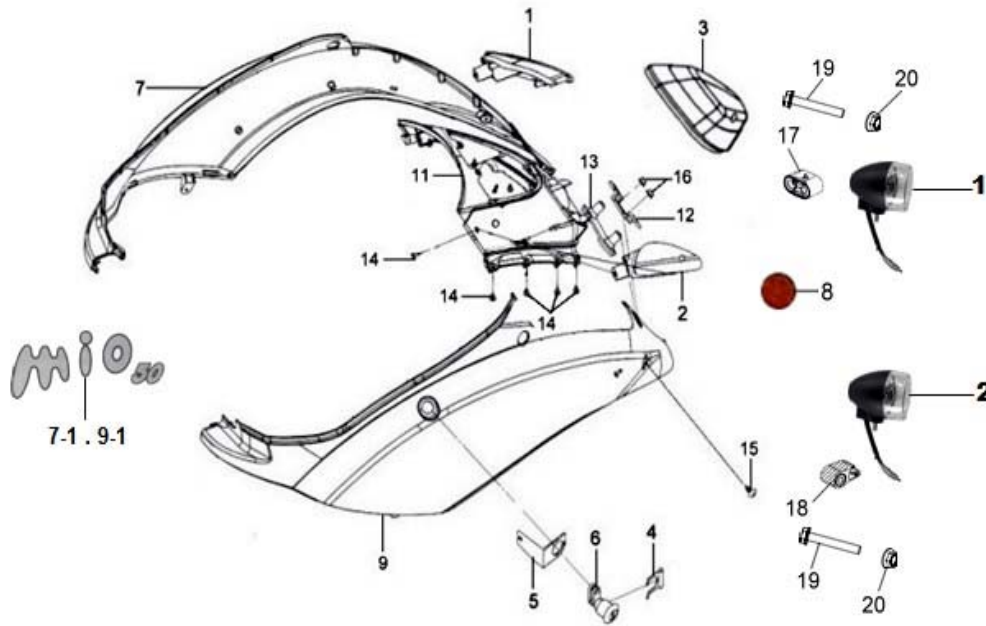

Pictures reference only

PARTS NUMBER	DESCRIPTION	QTY	EFFECTIVE DATE
9 8360G-A7A-600-VI	L BODY COVER ASSY.(R-200C)	1	
9-1 87128-A7A-600	BODY COVER STRIPE	1	
9 8360G-A7A-600-RD	L BODY COVER ASSY. (PK-1905P)	1	
9-1 87128-A7A-600	BODY COVER STRIPE	1	
9 8360G-A7A-600-AI	L BODY COVER ASSY. (BR-7529S)	1	
9-1 87128-A7A-600	BODY COVER STRIPE	1	
9 8360G-A7Y-000-FP	L BODY COVER ASSY.BU-288S/WH-009U	1	
9-1 87127-A7Y-000	BODY COVER STRIPE	1	
9 8360G-A7W-000-JU	L BODY COVER ASSY.BK-150C/WH-009U	1	
9-1 87128-A7W-000	L BODY COVER STRIPE	1	
9 83600-A8B-000-VI	L BODY COVER R-200CA	1	
9-1 87128-A7A-600	BODY COVER STRIPE	1	
9 83600-A8B-000-JL	L BODY COVER BK-150P	1	
9-1 87128-A7A-600	BODY COVER STRIPE	1	
9 83600-A8B-000-ZJ	L.BODY COVER RY-151C	1	
9-1 87128-A7A-600	BODY COVER STRIPE	1	
9 83600-A8B-000-AI	L.BODY COVER ASSY (BR-7529P)	1	
9-1 87128-A7A-600	BODY COVER STRIPE	1	
11 83751-A7M-000-KA	RR CENTER COVER BK-001U	1	
11 83751-A7M-000-QB	RR CENTER COVER WH-009U	1	
12 8470A-A7M-000	LICENSE PLATE BRKT. ASSY.	1	
12 8470A-A7M-010	LICENSE PLATE BRKT. ASSY	1	
13 84702-A8D-000	LICENSE PLATE BRKT STAY	1	
14 93903-34320	TAPPING SCREW 4X12	21	

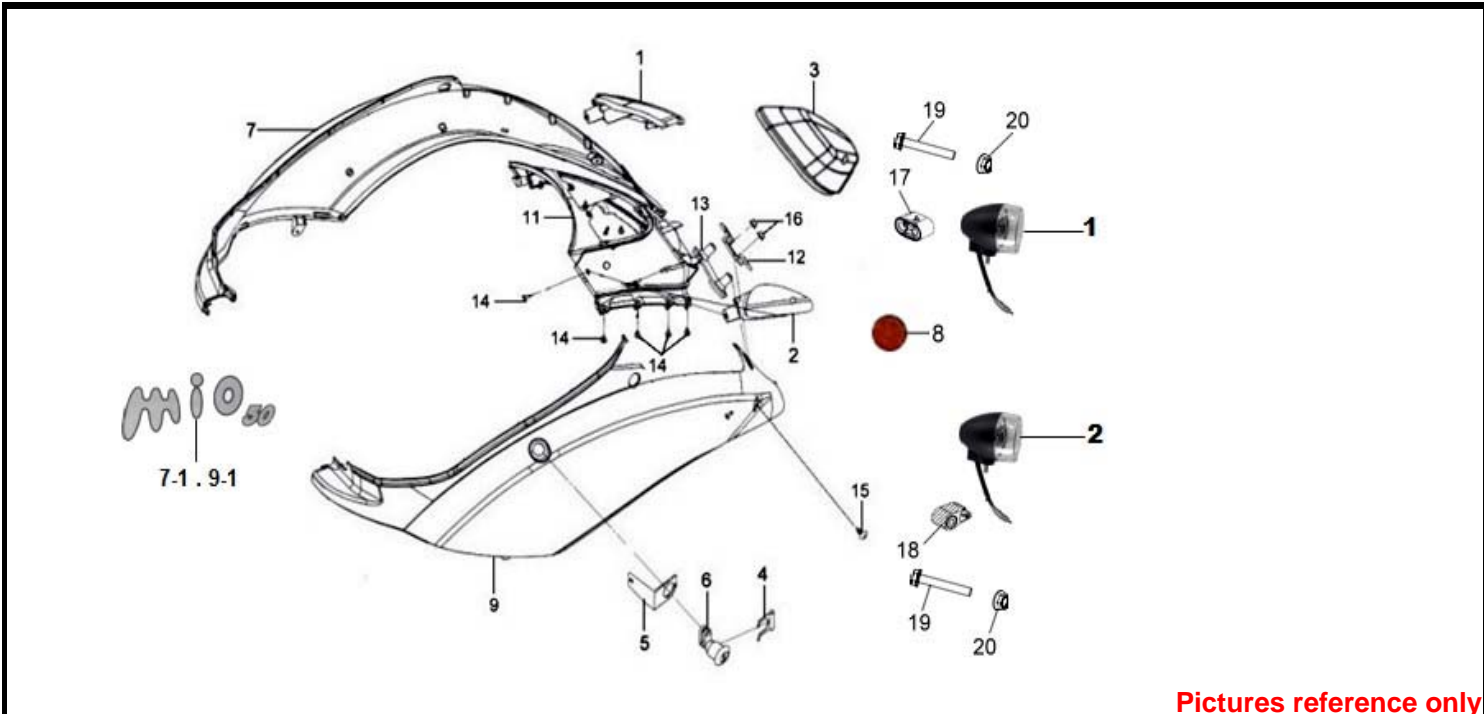

Pictures reference only

PARTS NUMBER	DESCRIPTION	QTY	EFFECTIVE DATE
15 93903-34480	TAPPING SCREW 4X16	2	
16 94050-06080	FLANGE NUT 6MM	2	
17 80107-A7M-000	RR.RH WINKER SEAT	1	
18 80108-A7M-000	RR.LH WINKER SEAT	1	
19 93891-06035-00	WASHER SCREW 6*35	2	
20 94050-06000	FLANGE NUT 6MM	2	



TEAMWORLD IND. 2005.08

※ Please check the color & stripe information according to the color index !